

CABLE PLUG FOR RG 402/U-TYPE 7-16

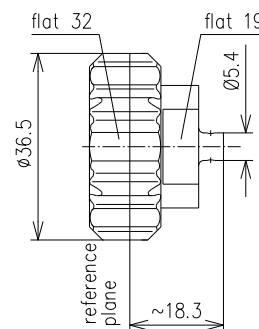

<b>Part number</b>	<b>BN 80 76 25</b>			
Connector type	7-16 plug			
Version	soldered			
Impedance	50 Ω			
Frequency range	0 - 1 GHz	1 - 2.7 GHz	2.7 - 6 GHz	6 - 8 GHz
VSWR	≤ 1.02	≤ 1.03	≤ 1.08	≤ 1.10
Intermodulation (IM3) 2x20W	≤ -165 dBc			
Proof voltage	1 kV			
Material and surface				
Inner conductor	copper alloy		silver-plated	
Outer conductor	copper alloy		silver-plated	
Other metal parts	copper alloy		bright nickel-plated	
Insulation	PTFE			
Sealing	silicone rubber			
Degree of protection	IP68 (mated)			
Cable compatibility	RG 402/U, semirigid flexible 141			
Standards	IEC 61169-4			
Installation instructions	M30595			
Weight	approx. 0.07 kg			
Included in delivery	installation instructions			
Delivery status	inner conductor attached separately			